

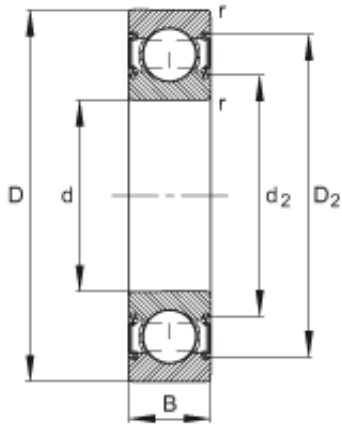

Handan Pangbo Bearings Sales Co., Ltd.



10 mm x 26 mm x 8 mm FAG 6000-C-2HRS Single Row Ball Bearings

Bearing No. 6000-C-2HRS

6000-C-2HRS Bearing 2D drawings and 3D CAD models

Size	10x26x8 mm
Bore Diameter	10 mm
Outer Diameter	26 mm
Width	8 mm
d	10 mm
D	26 mm
B	8 mm
D_2	23,4 mm
$D_{a \max}$	24 mm
d_2	13,4 mm
$d_{a \min}$	12 mm
$r_{a \max}$	0,3 mm
r_{\min}	0,3 mm
m	0,02 kg / Weight
C_r	5000 N / Dynamic load rating (radial)
C_{0r}	1970 N / Static load rating (radial)
n_G	28600 1/min / Limiting speed